

JRC is a complete customer centric enterprise operating in three principal business verticals - hospitality, infrastructure and realty which are designed to leverage its complementary competencies. As a result, high quality products and services are delivered at competitive prices. Synergy among business verticals help create new value curve by achieving both high quality and cost advantage. since its inspection it has delivered a wide range projects and services for its chosen segments which has made JRC become one of the emerging leaders in the field of realty development, infrastructure and hospitality. Today, the company is known for its integrity, ability to deliver projects on time with highest quality and stands as a proud statement of confidence and customer delight.



JRC
PALLADIO

“The only thing is eternal is a classical piece of architecture”





AN EXCLUSIVE COLLECTION OF ROMAN CLASSICAL VILLAS

- ❖ Based on the principles of the Legendary Italian Architect Andrea Palladio.
- ❖ 3/4 BHK with open to sky court yard, land, dining with landscaped deck, double height space living, multi purpose hall etc.
- ❖ Tree laden avenue road.
- ❖ Villa sizes range from 2100 SFT to 3800 SFT.
- ❖ Located at the heart of silicon triangle of Bangalore. Near Indus International School.
- ❖ Built by JRC Projects among the most admired infrastructure developers in India.



DREAM LOCATION

- ❖ Sarjapur that is both central and convenient
- ❖ Near Indus International School
- ❖ Amidst IT Parks and International Schools
- ❖ Very close to upcoming Wipro's Azim Premji University and Infosys Campus
- ❖ Within 10-30 minutes to all IT Hubs of Bangalore: Sarjapur Road & ORR, Electronic City and White Field



THE GATEWAY TO LIVING ROYALE



MASTER PLAN



- 40 X 60
- 40 X 50
- 30 X 60
- 30 X 50

- A Entrance Gate
- B Bus Bay
- C The Pond
- D Amphitheatre
- E Baroque Garden
- F Tennis Court
- G Basketball Court
- H Beach Volleyball Court
- I Swimming Pool
- J Kid's Play Area
- K Outdoor Gym
- L Chess Cum Yoga Deck
- M Mini Golf Putting
- N Club House

TYPE OF VILLAS & PLANS

VILLA SARACENO

East Facing Villa 40 X 60



West Facing Villa 40 X 60



◆ GROUND FLOOR PLAN ◆



◆ FIRST FLOOR PLAN ◆



◆ SECOND FLOOR PLAN ◆



SARACENO EAST | 12M X 18M | 4BHK | AREA 3735 SFT | ➤ N

◆ GROUND FLOOR PLAN ◆



◆ FIRST FLOOR PLAN ◆



◆ SECOND FLOOR PLAN ◆



SARACENO WEST | 12M X 18M | 4BHK | AREA 3688 SFT | N ◀



VILLA VICENZA

East Facing Villa 40 X 50



West Facing Villa 40 X 50





VICENZA EAST | 12M X 15M | 4BHK | AREA 3275 SFT | ► N

◆ GROUND FLOOR PLAN ◆

◆ FIRST FLOOR PLAN ◆

◆ SECOND FLOOR PLAN ◆



VICENZA WEST | 12M X 15M | 4BHK | AREA 3117 SFT | N ◀



VILLA TRISSINO

East Facing Villa 30 X 60



West Facing Villa 30 X 60



◆ GROUND FLOOR PLAN ◆



◆ FIRST FLOOR PLAN ◆



◆ SECOND FLOOR PLAN ◆



TRISSINO EAST | 9M X 18M | 4BHK | AREA 2810 SFT | ➤ N

◆ GROUND FLOOR PLAN ◆



◆ FIRST FLOOR PLAN ◆



◆ SECOND FLOOR PLAN ◆



TRISSINO WEST | 9M X 18M | 4BHK | AREA 2810 SFT | N ◀

VILLA VENETO

East Facing Villa 30 X 50



West Facing Villa 30 X 50



◆ GROUND FLOOR PLAN ◆



◆ FIRST FLOOR PLAN ◆



◆ SECOND FLOOR PLAN ◆



VENETO EAST | 9M X 15M | 3BHK | AREA 2095 SFT | ► N

◆ GROUND FLOOR PLAN ◆



◆ FIRST FLOOR PLAN ◆



◆ SECOND FLOOR PLAN ◆

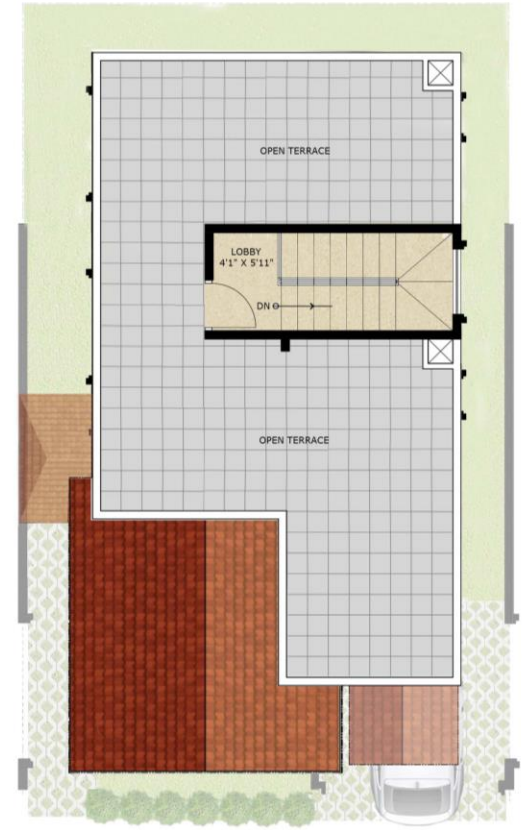

VENETO WEST | 9M X 15M | 3BHK | AREA 2126 SFT | N ◀



INTERIOR FOR THE VILLA



CLASSICAL CLUBHOUSE & AMENITIES



HIGH END AMENITIES



AMENITIES & CLUB HOUSE FACILITIES



Swimming Pool

Children Pool With Play Station

Day Care Center

Out Door Children Creche

Beach Volley Ball Court

Cricket Pitch

Tennis Court

Indoor Badminton Court

Squash Court

Billiards

Table Tennis Court

Chess Room, Carroms, Card Room

Gymnasium, Yoga/Aerobics Room

Spa

Saloon

Sauna & Steam Bath, Jacuzzi

Banquet Hall, Restaurant, Bar Lounge

Coffee Shop

Media Room

Children Play Room

Reading Room

Super Market

Guest Suites

Maintenance Office

Doctors Room

Golf Green Putting

INFRASTRUCTURE/UTILITIES

- ❖ Back Up Power - 100% Except For 15amp Sockets
- ❖ Solar
- ❖ Rain Water Harvesting
- ❖ Water Treatment Plant
- ❖ Sewage Treatment Plant
- ❖ Provision For DTH / Cable Connection
- ❖ Provision For Broad Band Connection
- ❖ Provision For Telephone
- ❖ Intercom & Landline Connected To Security

SPECIFICATIONS

STRUCTURE

RCC Framed Structure (Seismic Zone-II) With Solid Block Walls (150 mm Thick)

DOORS

Main Door Of Kelachandra :

Teak Wood Frame with Panelled Shutters with Dorset hardware fittings

Internal Doors Of Kelachandra:

Polished Timber Frame with Flush Shutters with Dorset hardware

Balcony Doors:

uPVC Doors with Mosquito Mesh

WINDOWS

uPVC Windows with Mosquito Mesh

VENTILATORS

uPVC With Glass Louvers

FLOORING

Entrance Lobby:

Lapotra Finish Granite Stone

Living, Dining, Kitchen and Passages:

Galvanised Tile

SPECIFICATIONS (continued...)

Bedrooms:

Laminated Wooden Flooring

Bathrooms:

Designer Ceramic Tiles

Balconies, Terrace and Utility:

Anti-Skid Ceramic Tiles

DADO

Kitchen:

2 Feet Band of Ceramic Tiles Above Granite Counter Top
Rest of The Walls with Premium Quality Emulsion

Bathrooms:

Designer Ceramic Tiles

STAIRCASE AND HAND RAILING

RCC Structural Staircase with Granite Finish
Cast Iron Designer Railing with MS hand Railing

KITCHEN

40 mm Thick Granite and Stainless-Steel Single Bowl with Drain Board

SPECIFICATIONS (continued...)

BATHROOMS:

Villeroy and Boch / Grohe / Toto For Sanitary and CP Fixtures and Fittings.

All Bedrooms Toilets- Granite top with Under Counter Wash-Basin with Hot and Cold-Water Mixture

Bedroom with Attached Toilet Shall Have a Shower Area with Hot and Cold mixture and Cockroach Trap

EWC And Wash-Basins Made from Villeroy and Boch / Grohe / Toto, Vitreous Ceramic Ware Health Faucet and Flush Valve in All Toilets

PAINTING:

Premium Emulsion Asian Paints on Internal Walls and Apex Asian Paints for Exterior Walls

ELECTRICAL:

Modular Switches of Anchor Roma

Power Supply: 9m X 15m-5kw, 9m X 18m & 12m X 15m-7kw, 12m X 18m-9kw

DG Back Up

EXTERNAL SECURITY:

24 Hour Manned Ground Security

CCTV At Strategic Points for Surveillance

Visitor Management Intercom Facility to Guard-House

ROUTE MAP



THANK YOU



Ph. 87 22 15 0000 | inquiry@jrcprojects.com